

Packaging item:	Ø45/41 x 178 mm	15,0 bar
Content net:	200 ml	
Date:	1-7-2011	
Internal code:	N/A	

Construction			
Material	Tin plate, Euro standard EN 10202		
Tin Coating	Body	E 2.0 / 2.0 Fine Stone	
	Bottom	E 2.8 / 2.8 Fine Stone	
	Top	D 4.0 / 2.8 Fine Stone	
Side seam	Soudronic Wima welded		
Lacquered, internal	Body	no inside lacquer	
	Side Stripe	no inside lacquer	
	Bottom	no inside lacquer	
	Top	no inside lacquer	
Lacquered, external	Body	outside plain	
	Bottom	clear varnish	
	Top	clear varnish	
Print	If, multicolored offset plus clear varnish		
Pressure specification	Deformation	minimum 15,0 bar	
	Burst pressure	minimum 18,0 bar	
Delivery and Identity	Cans in packaging referred to order (Compressionpack) at returnable pallets with foil wrapped against dirtiness		
Compound (double seam)	Nature- and synthetic latex		
Dimensions and capacities			
Can Height	178,0	tolerance	ref.
Nominal height	178,0	± 0.5 mm	E
Overall height	183,6	± 1.0 mm	F
Nom. fill volume (liq. prop.)	200		
Nom. fill vol. (compr. gas)			
Brimfull capacity (ml)	270	see FEA 214	
Weight (gr)	47,0	± 5%	
Body diameter	45,2	± 0.3 mm	D
1-inch opening internal	25,4	± 0.1 mm	A
1-inch opening external	31,20	± 0.15 mm	B
Contact height	4,00	± 0.15 mm	
Overseam diameter of cone	43,60	± 0.3 mm	C
Seam length of cone	2,90	± 0.15 mm	
Seam wall drop	5,30	± 0.5 mm	G

Packaging item:	Ø45/41 x 178 mm
Content net:	200 ml
Date:	1-7-2011
Internal code:	N/A

Miscellaneous	
Weight (gr)	47
Palletisation	3.000 stuks op pallet 1200*800
Remarks	
Minimum production	
Minimum deliverie	1 pallet

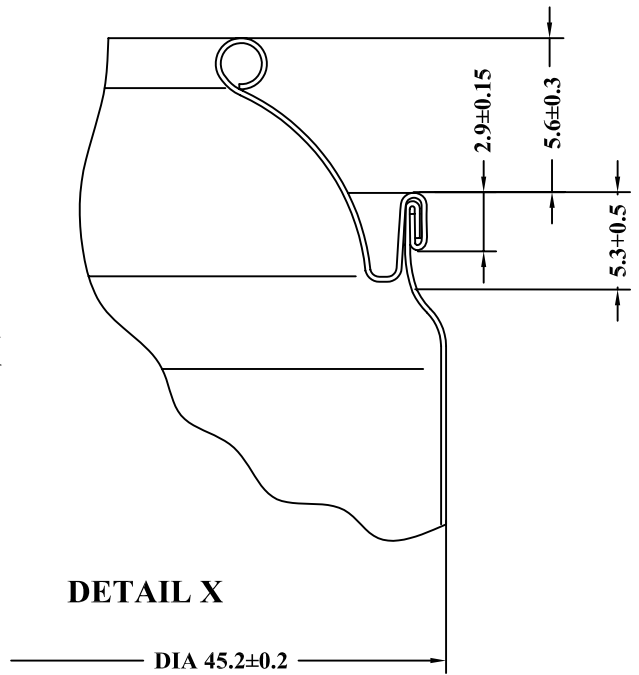
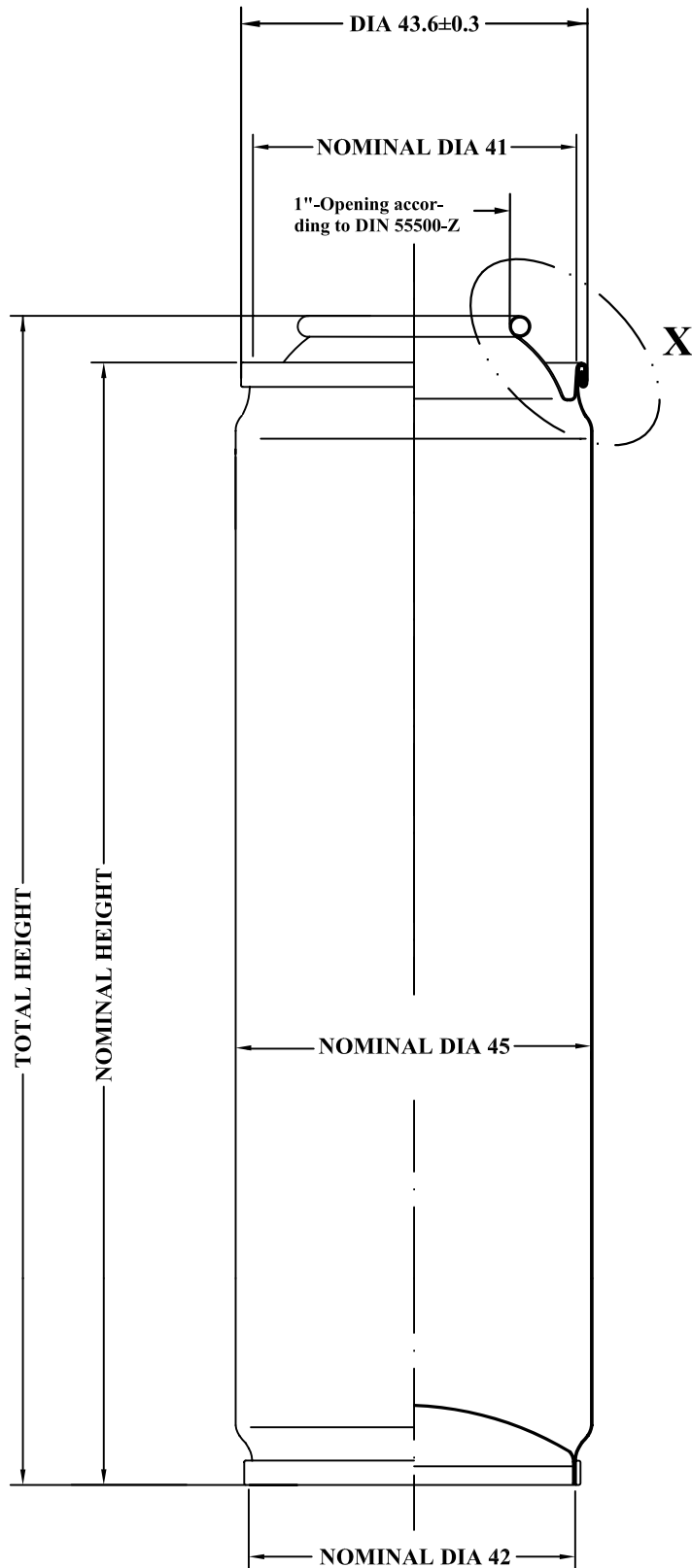

NOMINAL-HEIGHT mm	TOTAL HEIGHT ± 1 mm	BRIMFUL CAPACITY ml	NOMINAL CAPACITY ml
096	101.6	140	100
118	123.6	175	125
140	145.6	210	150
178	183.6	270	200

DIMENSIONS GIVEN IN mm

Aerosol can acc. to the
 - 13. GPSGV-Aerosolpackungsverordnung
 - guideline 75/324/EEC.